

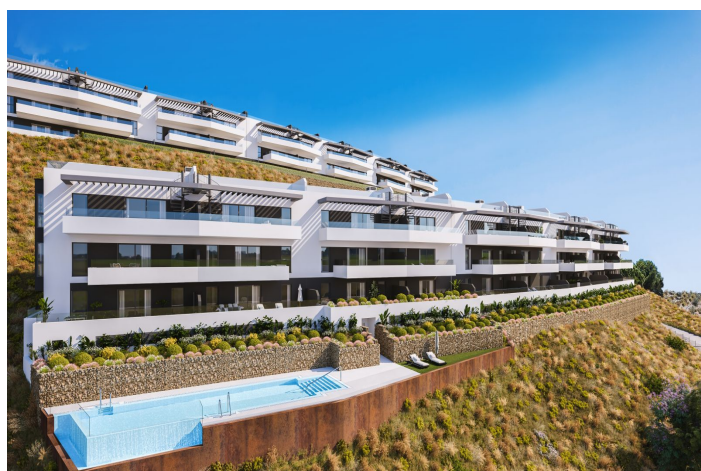

Appartement au rez-de-chaussée à vendre à Rincón de la Victoria 410 000 - 477 000 €

Référence: R4362811 Chambres: 2 - 3 Bain: 2 Terrain: 21m² - 30m² Construite: 85m² - 94m² Terrasse: 23m² - 64m²

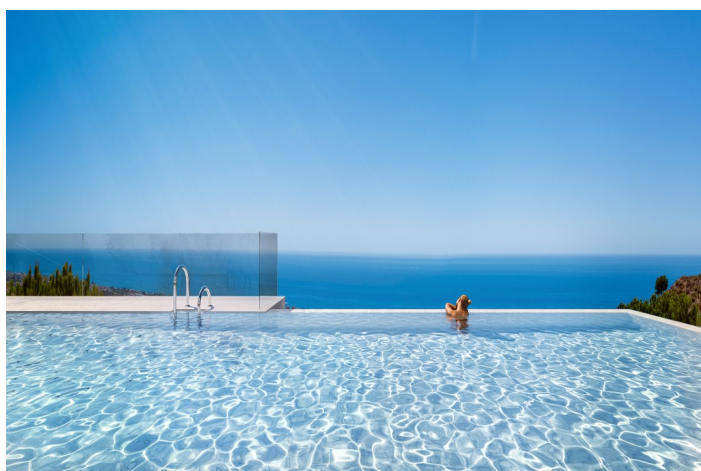



Costa del Sol East, Rincón de la Victoria

Nature and architecture blend together in this development, a project inspired by the tranquility and privacy of the Indonesian islands. Both its avant-garde homes and its complete common areas are distributed to integrate into the environment. With the vegetation and the landscape as a backdrop, this development opens up to the spectacular views of the bay of Malaga, without giving up the panoramic view that surrounds the complex. This development is in an unbeatable location, away from the hustle and bustle of the Costa del Sol, but close to everything you need. A location of great scenic value that combines the best of the sea and the mountains. Nature in its purest form just 20 minutes from the center of Malaga, 30 from the international airport and less than an hour from Marbella. All the services you need, direct access to the A-7 and the beach 10 minutes away. Although if your thing is hiking or rafting, you have less than an hour to the Genil River and the natural parks of the mountains of La Tejada, Alminara and Alhama; Also Los Montes de Málaga a step and half an hour from the La Viñuela reservoir, where you can practice canoeing and bathe in its turquoise waters. And, if golf is your thing, it will only take you 6 minutes to get to the Añoreta course. To make the most of its extraordinary location, we have counted on a prestigious architectural firm in Malaga with extensive experience and extensive knowledge of the terrain. His approach has been as simple as it is effective; arrange the buildings in a linear manner on the viewpoint of La Zenaida, where the buildings and their large terraces emerge as strata of the mountain itself. A cliff with angular shapes at the base of which an impressive infinity pool extends, from which the sensation of weightlessness lifts us above the horizon. From the endless terraces of this development, the simple passing of the day becomes a spectacle. For this reason, we have wanted to incorporate the exterior into each space of your home. And to achieve this, we have chosen to install large windows in the large space that forms the living room with its large open kitchen. You just have to open them and let the breeze and the Mediterranean sun be part of your home.



Spécification:

Caractéristiques

- Terrasse couverte
- Pièce de stockage
- Salle de bain
- Armoires encastrées
- Buanderie
- Salle de sport

Vues

- Mer
- Montagne
- Panoramique
- Piscine

Piscine

- Communautaire
- Private

Sécurité

- Complexe fermé

Orientation

- Sud-Est

Paramètre

- Près de la ville

Cuisine

- Entièrement équipée

Parking

- Souterrain
- Garage
- Communautaire

Contrôle du climat

- Cold A / C
- A / C chaud

Condition

- Excellent

Jardin

- Communautaire
- Private
- Aménagé

Catégorie

- Nouveau développement