

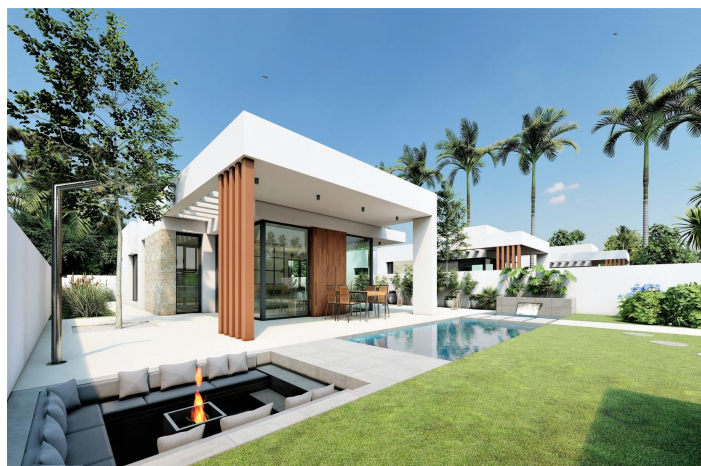

## Villa for sale in San Fulgencio

660,000 €

Reference: N7374   Bedrooms: 3   Bathrooms: 2   Plot Size: 500m<sup>2</sup>   Build Size: 135m<sup>2</sup>   Terrace: 27m<sup>2</sup>

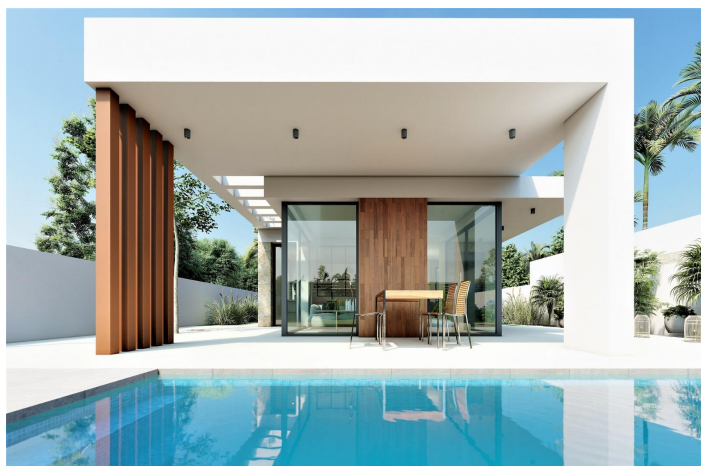



---

## La Vega Baja, San Fulgencio

NEW BUILD VILLAS IN SAN FULGENCIO&#13;&#13;New Build villas San Fulgencio, just 5 km from the beach.&#13;&#13;The villas offer 3 bedrooms, 2 bathrooms and spacious kitchen, dining room, living room, swimming pool with waterfall and two pools: splash pool measuring 1.95x2.60 m and 0.6 m deep, and pool measuring 5.60x2.60 m, between 1 and 1.5 m variable depth.&#13;&#13;A large south facing porch allows the continuity of the living room with the outside, opening up to a modern and functional outdoor space where you can enjoy the private swimming pool, barbecue, chillout and large garden area that surrounds it.&#13;&#13;The simple and clear lines of the furniture contribute to its integration with the rest of the house. Wooden details add warmth to the atmosphere. Bathrooms where colour combined with natural and warm tones, create a cosy atmosphere, which together with the direct relationship with the outside ,allows you to connect with nature, achieving great moments of relaxation. The master bedroom has a private patio, which together with the light that penetrates through its windows, creates a relaxing atmosphere, perfect for rest and relaxation.&#13;&#13;San Fulgencio is a pleasant village with several restaurants and shops and the location is very good with its proximity to the fantastic beaches of La Marina and the slightly larger town of Guardamar.&#13;&#13;The town of San Fulgencio is situated around 30 minutes from Alicante-Elche airport, 6 km from the nearest golf course and just 5 km from the nearest beach.&#13;



Features:

Features

- Private pool
- Parking - Space
- BBQ
- Number of Parking Spaces: 1
- Beach: 5000 Meters
- Gated
- Air Conditioning: Pre-Installed
- Location: Coastal
- Double Bedrooms: 3
- garden
- Useable Build Space: 105 Msq.
- Terrace: 27 Msq.

Energy Rating

B

CO2 Emission Rating

B