

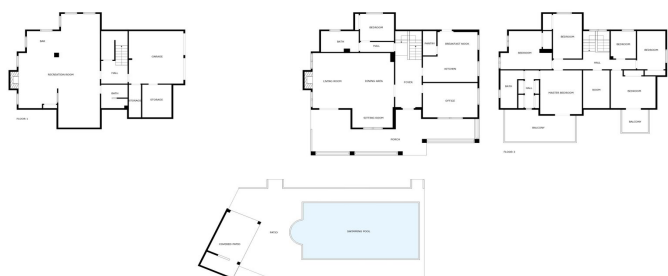

Townhouse for sale in Alhaurín de la Torre

765,000 €

Reference: R4884943 Bedrooms: 8 Bathrooms: 4 Plot Size: 1,427m² Build Size: 420m²



SIZES ARE APPROXIMATE, ACTUAL MAY VARY.





Malaga Inland, Alhaurín de la Torre

Located in the elevated neighbourhood of El Lagar in the popular village of Alhaurín de la Torre, this house is an exceptional opportunity for those seeking both space and tranquility. Perfectly suited for large families, this home combines a serene residential setting with easy access to all essentials and just a 10-minute drive to the nearest beach, Plaza Mayor shopping mall, and Málaga Airport. The property, with its traditional feeling and decoration, presents beautiful and well kept outside areas, such as a large swimming pool, gardens and covered terraces where you can enjoy some shade during the hot summer days. The home is thoughtfully developed over three levels: When entering the house, there is a spacious and inviting living room featuring a cozy, functional fireplace, perfect for family gatherings. Additionally, there is a fully fitted kitchen with dining area, a study, a bright guest bedroom, and a full bathroom on this same floor. The upper level boasts six bedrooms and two bathrooms, one of which is ensuite and belongs to the master bedroom. Two of the bedrooms have direct access to southeast-facing terraces, providing panoramic views of Málaga's cityscape and the surrounding mountains. On the lower level of the property, there is a generous living area with fireplace and a small kitchen, ideal to spend the winter evenings with family and friends. On the same level there are also a bathroom, 3 storage areas and a garage for 2 cars. Don't miss the chance to make this exquisite family residence your new home in the heart of Alhaurín de la Torre.



Features:

Features

Covered Terrace
Near Transport
Private Terrace
Storage Room
Ensuite Bathroom
Double Glazing
Fitted Wardrobes
Utility Room
Barbeque
Fiber Optic
Guest Apartment
Bar
Near Church
Solarium
Games Room
Basement

Setting

Close To Shops
Close To Schools
Close To Town

Utilities

Telephone

Climate Control

Fireplace

Views

Mountain
Panoramic
Country
Garden
Pool

Pool

Private

Furniture

Fully Furnished